

MKF 1664 BM

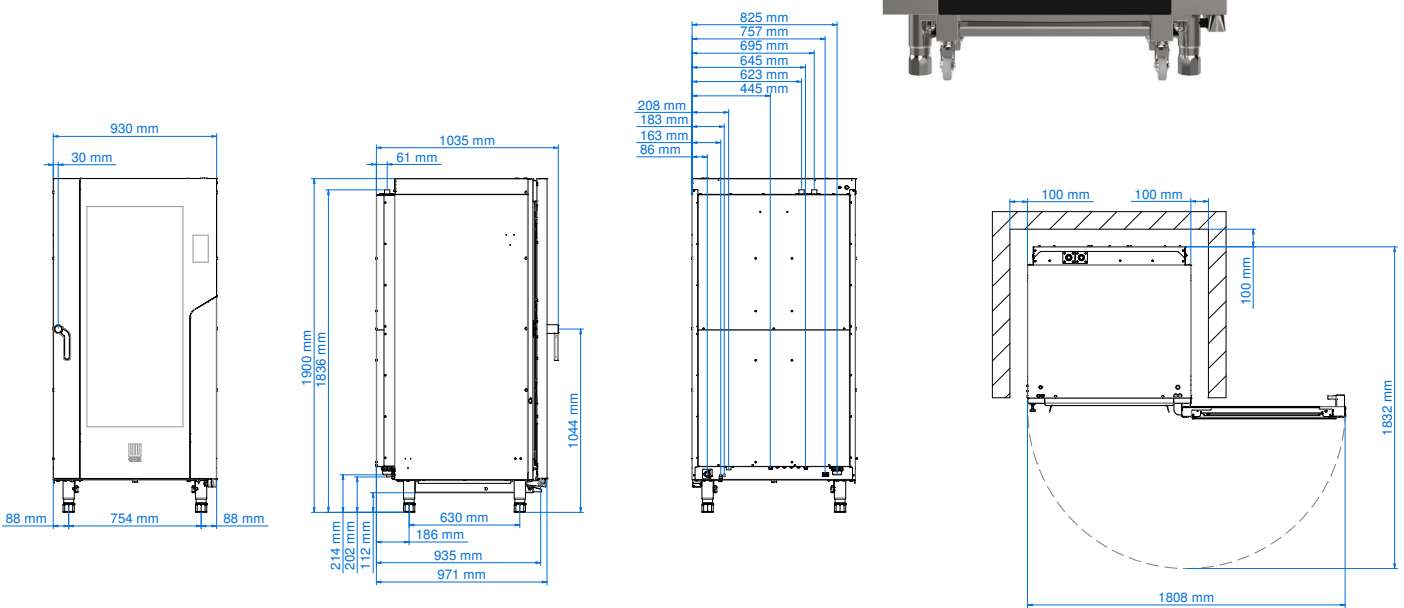

Electric combi oven 16 trays 600 x 400 mm
with digital touch panel with
BLACK MASK technology



Dimensional features

Dimensions (WxDxH mm)	930 x 1035 x 1900
Weight (kg)	247,2
Distance between rack rails (mm)	80

Electrical features

Power supply (kW)	31
Frequency (Hz)	50/60
Voltage (V)	AC 380/400 3N
N° motors	4 bidirectionals
Boiler (kW)	/
Protection against water	IPX4

Functional features

Power	Electricity
Capacity	16 trays/grids 600 x 400 mm
Type of cooking	Semistatic + ventilated
Steam	Direct steam controlled by touch screen (10 levels)
Cooking chamber	AISI 304 stainless steel
Temperature	30 - 270 °C
Temperature control	2 Digital probe thermometers
Control panel	Black mask electronic control
N° programs	100
Programmable cooking steps	10
Pre-heating temperature	180 °C
Pre-heating function	Programmable
Door	Right side opening Ventilated Inspectionable glass
Feet	Adjustable

Optionals

Condensation hood	MKKC 1620
Trolleys	EKCR 16TC EKCR 1664
Other accessories	Available in the dedicated section

Equipment

Cardboard box dimensions with pallet (WxDxH mm)	1146 x 1260 x 2090 mm
USB port	
Core probe predisposition	
Automatic washing system predisposition	
Hinge with door locking for openings adjusted at 60°, 90°, 120°, 180°	
Trolley with removable handle and braked wheels cod. EKCR 16TC	

Plus

Patented fan guard system Airflowlogic™	
Patented system for direct steam Humilogic™	
Available on request at the order	Voltage (V) : AC 220/230 3 PH Left side opening door
Humidity management software	
Programmable oven start	
N° 40 recipes stored	
HACCP system	
Adjustable door hinges	